



3D Drawing are for illustrational purposes only and do not represent the actually finishes and or fixtures.

The Maverick
 16' x 36' Gambrel Cabin w/Decks

This document is for illustrational purposes only (it has not been reviewed by an architect or engineer unless otherwise stated in or on this document) and should not be relied on for any purpose other than illustration and general layout of building.
 Wolf Valley Buildings, LLC and affiliates assume no liability or responsibility for any mistakes, or errors herein.
 All rights reserved by Wolf Valley Buildings, LLC. This document and the information contained herein are confidential and protected from disclosure pursuant to Federal law. Use, dissemination, or copying of this information is strictly prohibited. If you received this document in error, please erase all copies and attachments and notify the sender immediately.
 Customer Responsible to verify all local, state, and any jurisdictional codes and building requirements.



Original Doc. Date
 12/10/2025
 Revision Date
 02/23/2026
 Revision #
 R2h

- Door & Window Schedule**
- 1 3068RH Radiant Star Entry Door
 - 1 3068 9-lite Entry Door
 - 1 2068 Pine Door (Barn)
 - 1 2068 Pine Door (Barn)
 - 1 2668RH Pine Door
 - 1 2868 Pocket Door
 - 1 2030SH Window
 - 4 3040SH Windows
 - 2 3050SH Windows

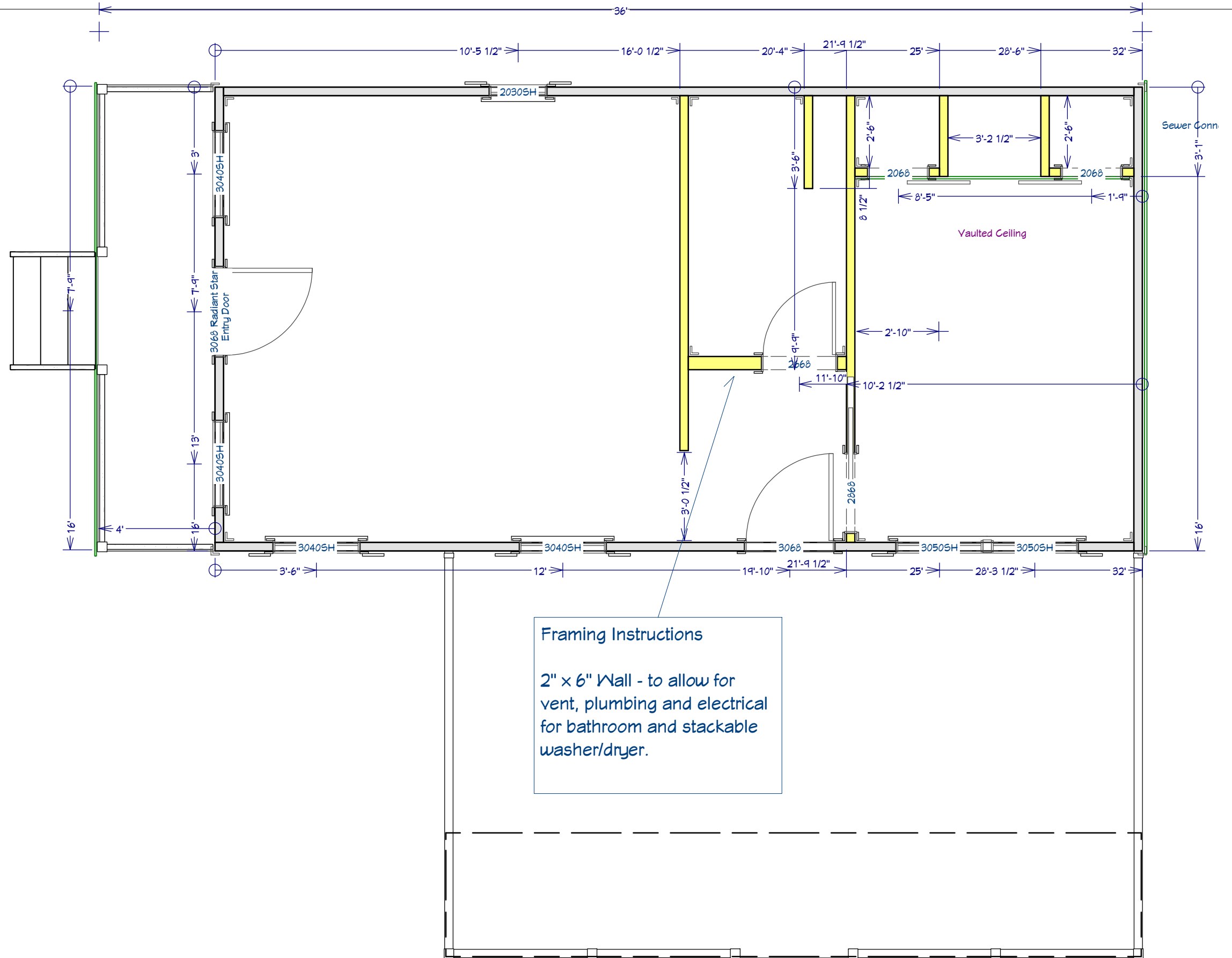

Framing Instructions

2" x 6" Wall - to allow for vent, plumbing and electrical for bathroom and stackable washer/dryer.

The Maverick

16' x 36' Gambrel Cabin w/Decks

This document is for illustrational purposes only (it has not been reviewed by an architect or engineer unless otherwise stated in or on this document) and should not be relied on for any purpose other than illustration and general layout of building.

Wolf Valley Buildings, LLC and affiliates assume no liability or responsibility for any mistakes, or errors herein.

All rights reserved by Wolf Valley Buildings, LLC. This document and the information contained herein are confidential and protected from disclosure pursuant to Federal law. Use, dissemination, or copying of this information is strictly prohibited. If you received this document in error, please erase all copies and attachments and notify the sender immediately.

Customer Responsible to verify all local, state, and any jurisdictional codes and building requirements.



Original Doc. Date
12/10/2025

Revision Date
02/23/2026

Revision #
R2h

Framing

Page 2 of 8

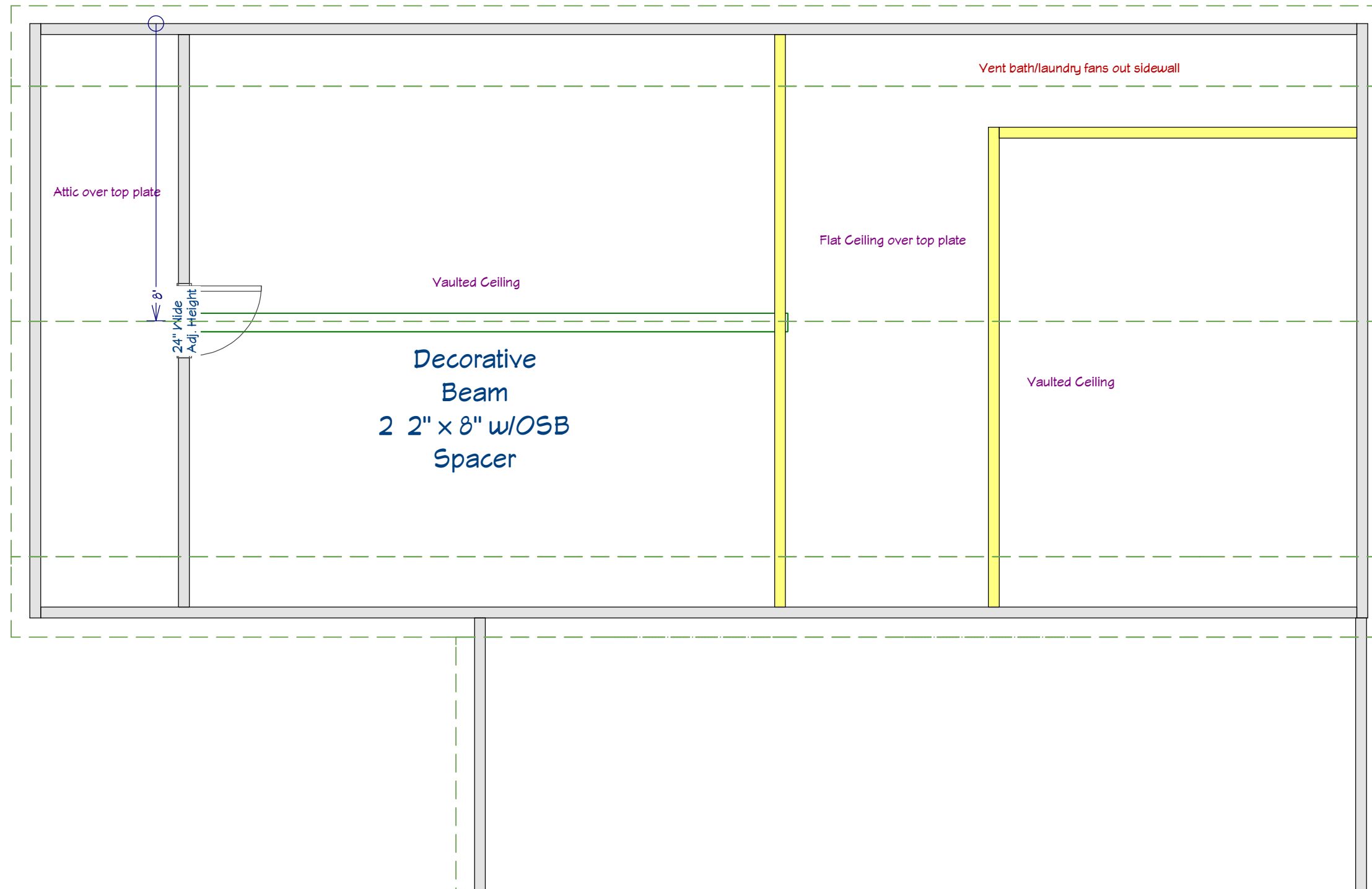

The Maverick
16' x 36' Gambrel Cabin w/Decks

This document is for illustrational purposes only. It has not been reviewed by an architect or engineer unless otherwise stated in or on this document and should not be relied on for any purpose other than illustration and general layout of building.
Wolf Valley Buildings, LLC and affiliates assume no liability or responsibility for any mistakes, or errors herein.
All rights reserved by Wolf Valley Buildings, LLC. This document and the information contained herein are confidential and protected from disclosure pursuant to Federal law. Use, dissemination, or copying of this information is strictly prohibited. If you received this document in error, please erase all copies and attachments and notify the sender immediately.
Customer Responsible to verify all local, state, and any jurisdictional codes and building requirements.



Original Doc. Date
12/10/2025
Revision Date
02/23/2026
Revision #
R2h

Loft Framing
Page 3 of 8

\$\$\$	2 Gang Switch	⊙	Outlet
⊙	220V Outlet	⊙	Pendant Light
\$\$\$\$	3 Gang Switch	⊙	Porch Light
⊙	Bare Bulb	⊙	Recessed Light
CAT Stubout	CAT Line Stubout	⊙	Sconce Light
⊙	CAT6 w/TV	⊙	Smoke Detector
⊙	Ceiling Fan	⊙	Smoke Detector
⊙	Chandelier	⊙	Spot Light
⊙	CO Detector	⊙	Switch
⊙	Electrical Connection	⊙	Three Way Switch
EP	Electrical Panel Box	⊙	Through Wall Fan
⊙	Exhaust Fan	⊙	Under Cabinet Light
⊙	Exhaust Fan - Range	⊙	Vanity Light
⊙	Flush Mount Light	⊙	Water Proof 220V Outlet
4	Four Way Switch	⊙	Water Proof Ground Fault Outlet
GFCI	Ground Fault Outlet	⊙	Water Proof Outlet

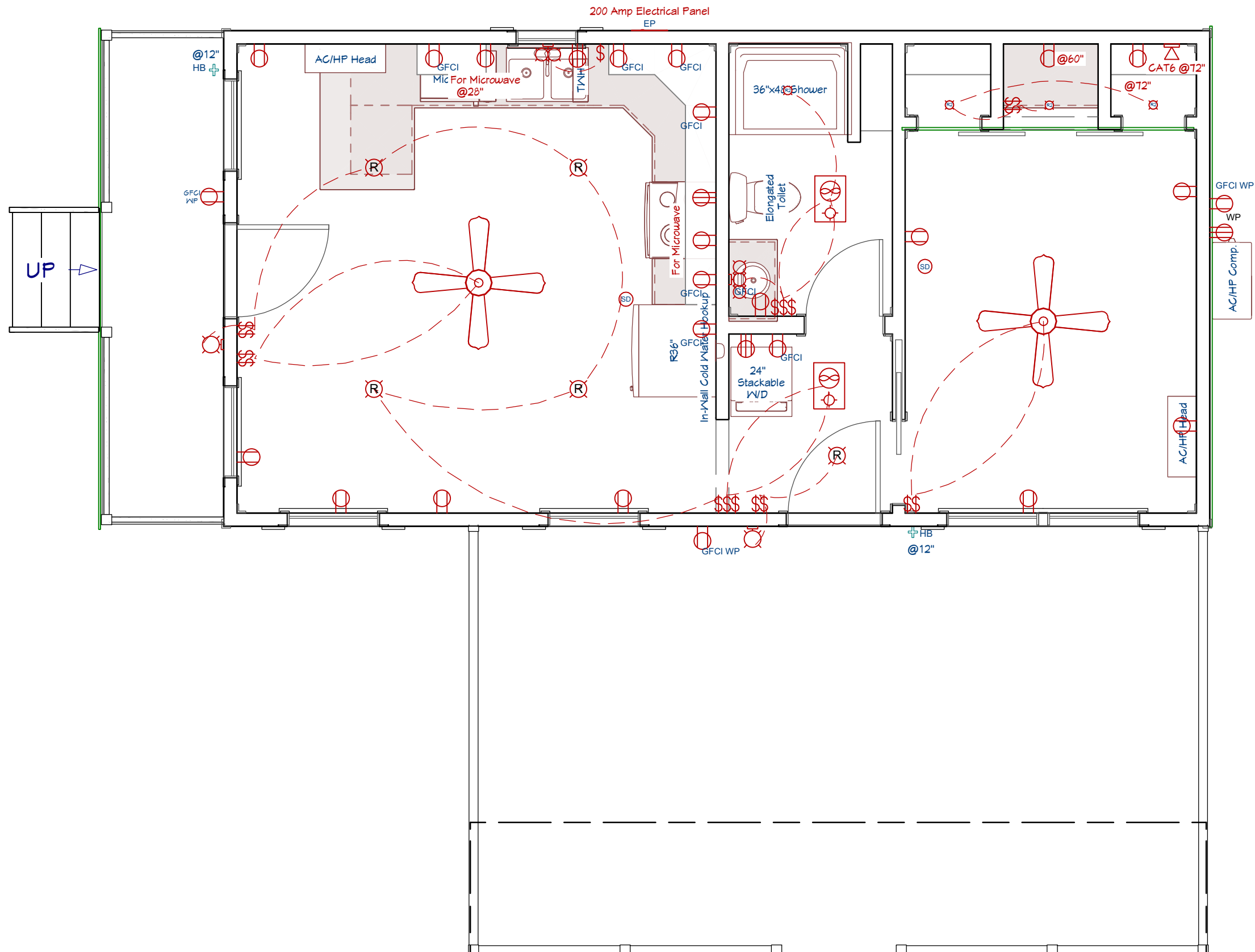

The Maverick
 16' x 36' Gambrel Cabin w/Decks

This document is for illustrational purposes only (it has not been reviewed by an architect or engineer unless otherwise stated in or on this document) and should not be relied on for any purpose other than illustration and general layout of building.
 Wolf Valley Buildings, LLC and affiliates assume no liability or responsibility for any mistakes, or errors herein.
 All rights reserved by Wolf Valley Buildings, LLC. This document and the information contained herein are confidential and protected from disclosure pursuant to Federal law. Use, dissemination, or copying of this information is strictly prohibited. If you received this document in error, please erase all copies and attachments and notify the sender immediately.
 Customer Responsible to verify all local, state, and any jurisdictional codes and building requirements.



Original Doc. Date
12/10/2025
 Revision Date
02/23/2026
 Revision #
R2h

Electrical
 Page 4 of 8

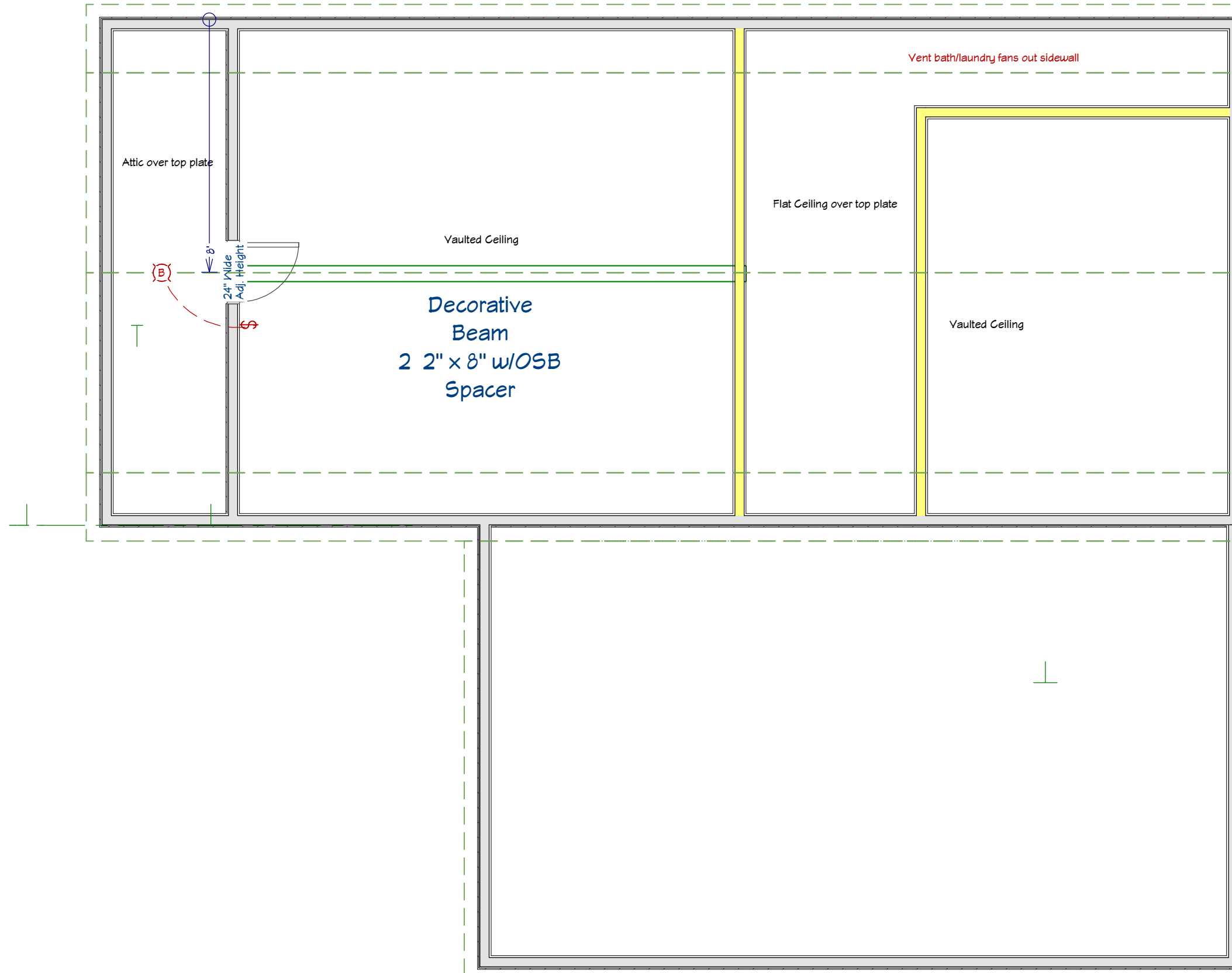

T

T

The Maverick
 16' x 36' Gambrel Cabin w/Decks

This document is for illustrational purposes only (it has not been reviewed by an architect or engineer unless otherwise stated in or on this document) and should not be relied on for any purpose other than illustration and general layout of building.
 Wolf Valley Buildings, LLC and affiliates assume no liability or responsibility for any mistakes, or errors herein.
 All rights reserved by Wolf Valley Buildings, LLC. This document and the information contained herein are confidential and protected from disclosure pursuant to Federal law. Use, dissemination, or copying of this information is strictly prohibited. If you received this document in error, please erase all copies and attachments and notify the sender immediately.
 Customer Responsible to verify all local, state, and any jurisdictional codes and building requirements.



Original Doc. Date
 12/10/2025
 Revision Date
 02/23/2026
 Revision #
 R2h

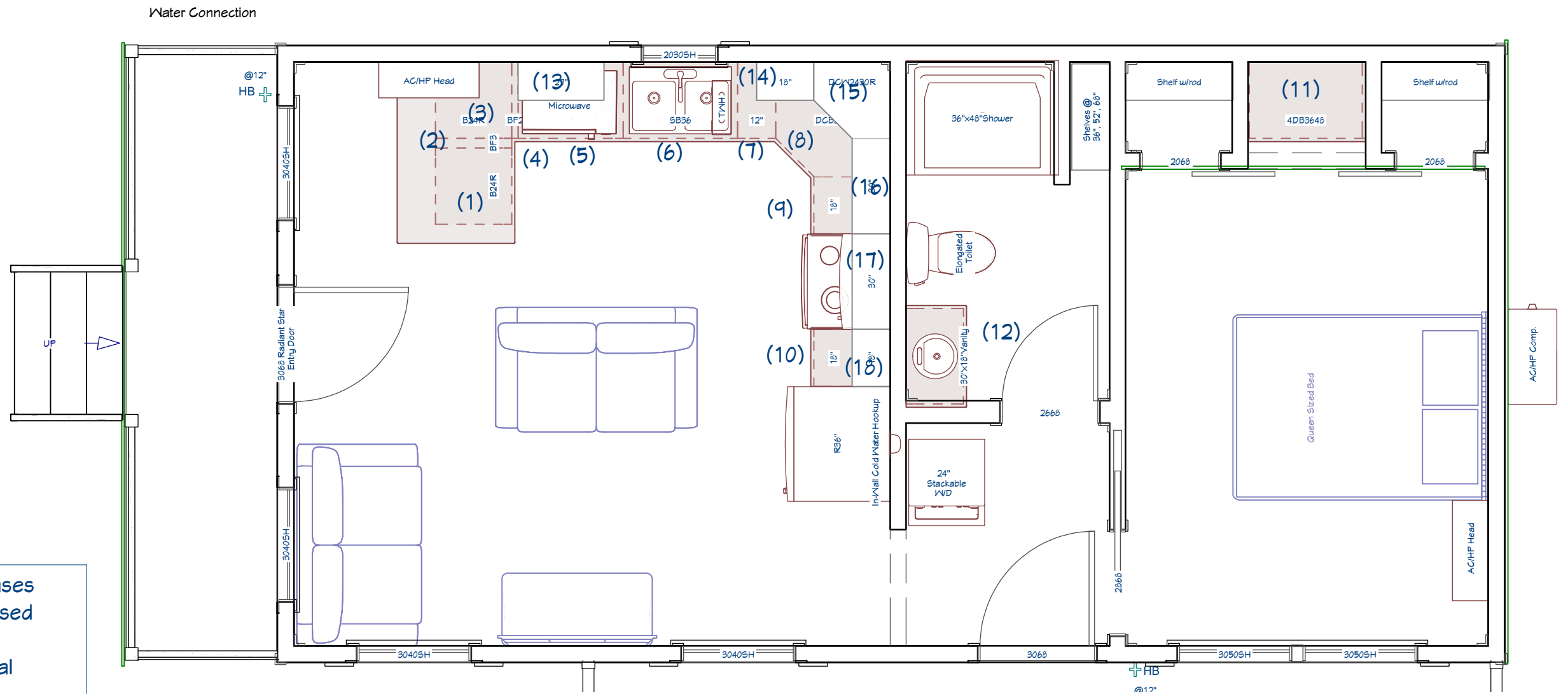

Cabinets: Kitchen Bases
 Style: White Oak Raised Panel
 Color: Stained Special Walnut

- 1) 24" x 24" Base'
- 2) 3" Filler
- 3) 24" x 24" Base (No upper drawer- open towards window)
- 4) 2" Filler
- 5) 33" x 24" Base (17" High opening for Microwave, drawer under)
- 6) 36" x 24" Sink Basin
- 7) 12" x 24" Base
- 8) 36" x 24" Lazy Susan
- 9) 18" x 24" Base
- 10) 18" x 24" Drawer Bank

Cabinets: Kitchen Uppers
 Style: White Oak Raised Panel
 Color: Stained Special Walnut

- 13) 27" x 30" Upper
- 14) 18" x 30" Upper
- 15) 24" x 30" Upper Corner
- 16) 30" x 30" Upper
- 17) 30" x 12" Upper
- 18) 18" x 30" Upper

Cabinets: Bathroom/Bedroom
 Style: White Oak Shaker
 Color: Stained Special Walnut

- 11) 36" x 40" x 24" Dresser (4 Drawers)
- 12) 30" x 18" Vanity

The Maverick

16' x 36' Gambrel Cabin w/Decks

This document is for illustrational purposes only (it has not been reviewed by an architect or engineer unless otherwise stated in or on this document) and should not be relied on for any purpose other than illustration and general layout of building.

Wolf Valley Buildings, LLC and affiliates assume no liability or responsibility for any mistakes, or errors herein.

All rights reserved by Wolf Valley Buildings, LLC. This document and the information contained herein are confidential and protected from disclosure pursuant to Federal law. Use, dissemination, or copying of this information is strictly prohibited. If you received this document in error, please erase all copies and attachments and notify the sender immediately.

Customer Responsible to verify all local, state, and any jurisdictional codes and building requirements.



Original Doc. Date
12/10/2025

Revision Date
02/23/2026

Revision #
R2h

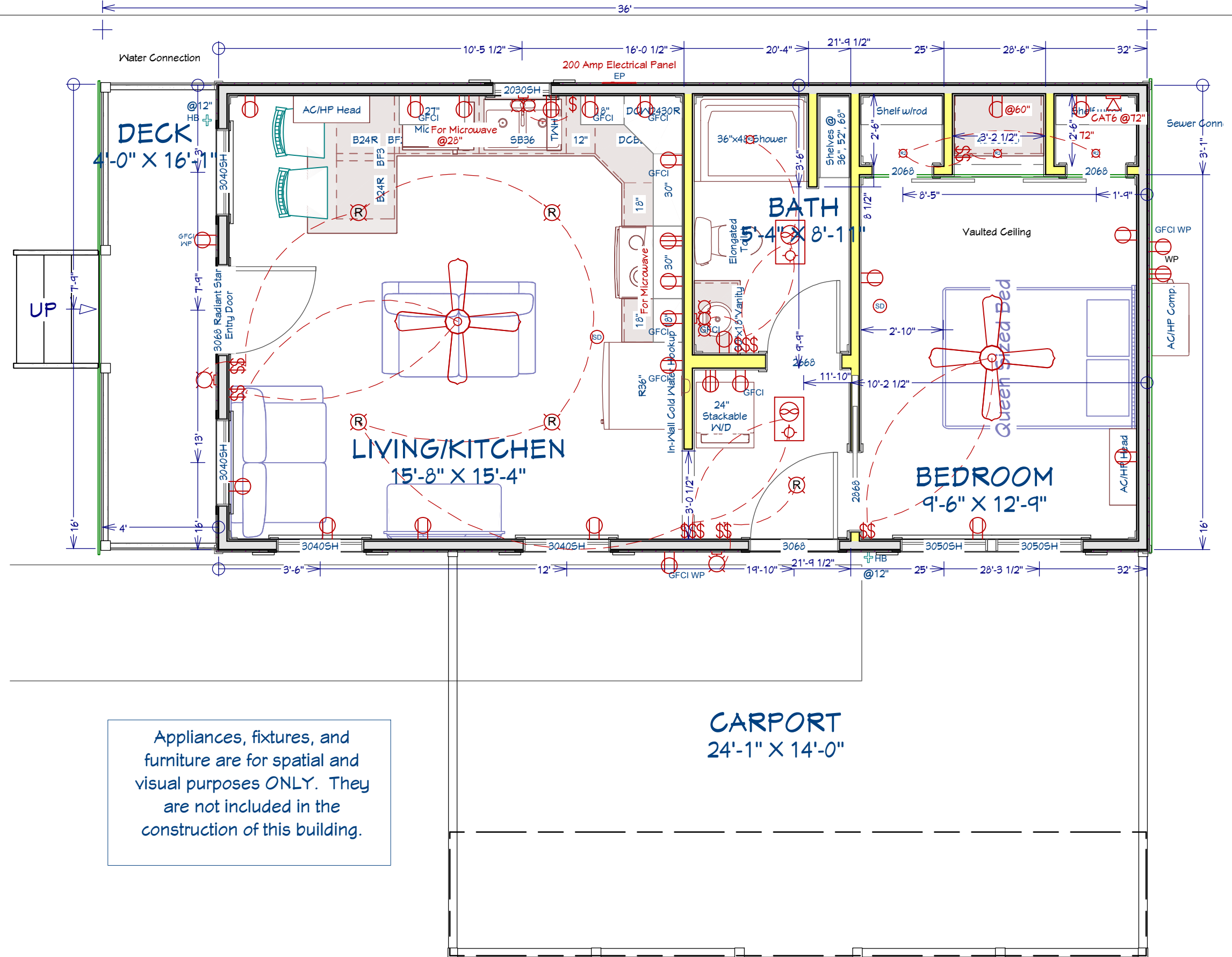

Appliances, fixtures, and furniture are for spatial and visual purposes *ONLY*. They are not included in the construction of this building.

The Maverick
 16' x 36' Gambrel Cabin w/Decks

This document is for illustrational purposes only (it has not been reviewed by an architect or engineer unless otherwise stated in or on this document) and should not be relied on for any purpose other than illustration and general layout of building.
 Wolf Valley Buildings, LLC and affiliates assume no liability or responsibility for any mistakes, or errors herein.
 All rights reserved by Wolf Valley Buildings, LLC. This document and the information contained herein are confidential and protected from disclosure pursuant to Federal law. Use, dissemination, or copying of this information is strictly prohibited. If you received this document in error, please erase all copies and attachments and notify the sender immediately.
 Customer Responsible to verify all local, state, and any jurisdictional codes and building requirements.



Original Doc. Date
 12/10/2025
 Revision Date
 02/23/2026
 Revision #
 R2h

All Layers
 Page 7 of 8

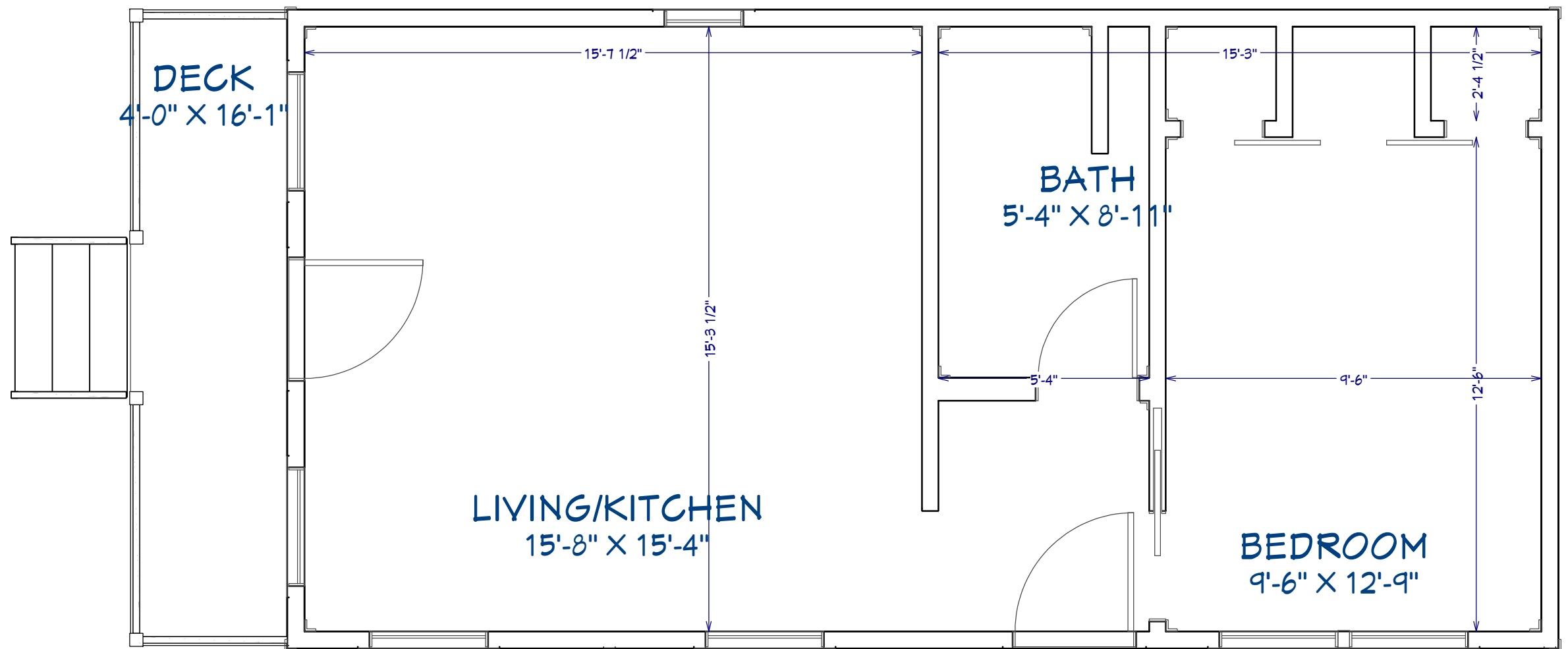

Room dimension measurements are approximate only. All floor plan measurements override these measurements. These measurements may differ 1-4" depending on wall coverings, trims, etc.